

UK Oncology FORUM 2026

USEFUL INFORMATION

Thursday 11th June & Friday 12th June 2026
Harrogate Convention Centre

The Secretariat

Athena Meetings & Events is a medical events agency and secretariat that support the UK Oncology Forum to deliver a seamless, high quality educational conference.



Athena Medical PR Limited (trading as Athena Meetings & Events)
2 Kingdom Street, 6th Floor, London, Greater London, W2 6BD, UK
Company number **03452033**

Website: www.oncology-forum.co.uk

Direct Line: +44 (0) 1625 619450

Please visit the UK Oncology Forum website for regular updates to the programme etc – www.oncology-forum.co.uk

2026 UK Oncology Forum Conference Venue

We are delighted to be holding the UK Oncology Forum conference at the Harrogate Convention Centre on Thursday 11th & Friday 12th June 2026.

Harrogate Convention Centre

King's Road

Harrogate HG1 5LA

[Harrogate Convention Centre Website](#)



Meeting Rooms: -

Main Auditorium – Plenary
Studio One – Exhibition Hall
Queen Suite 1
Queen Suite 2
Queen Suite 3
Queen Suite 4
Queen Suite 5
Kings Suite

Card Payments Only - please be aware Harrogate Convention Centre now accepts Card & Contactless payments only

Crowne Plaza Harrogate, an IHG Hotel (adjoining to Convention Centre)

King's Road

Harrogate

HG1 1XX

[Crown Plaza Website](#)

Meeting Rooms: -

Harewood 1	Ground Floor
Harewood 2	Ground Floor
Ripley Suite	First Floor
Bramham Suite	First Floor

[HCC Visitor Discount Offers - Harrogate Convention Centre](#)



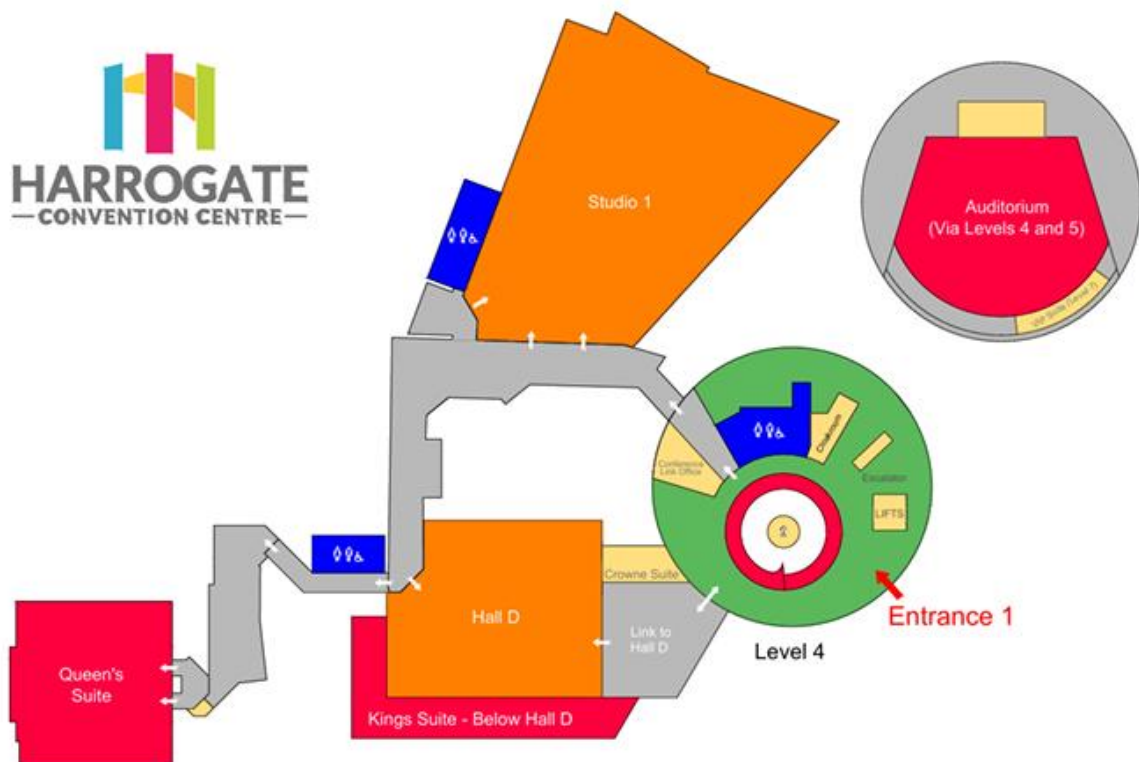

Queens Suites:-

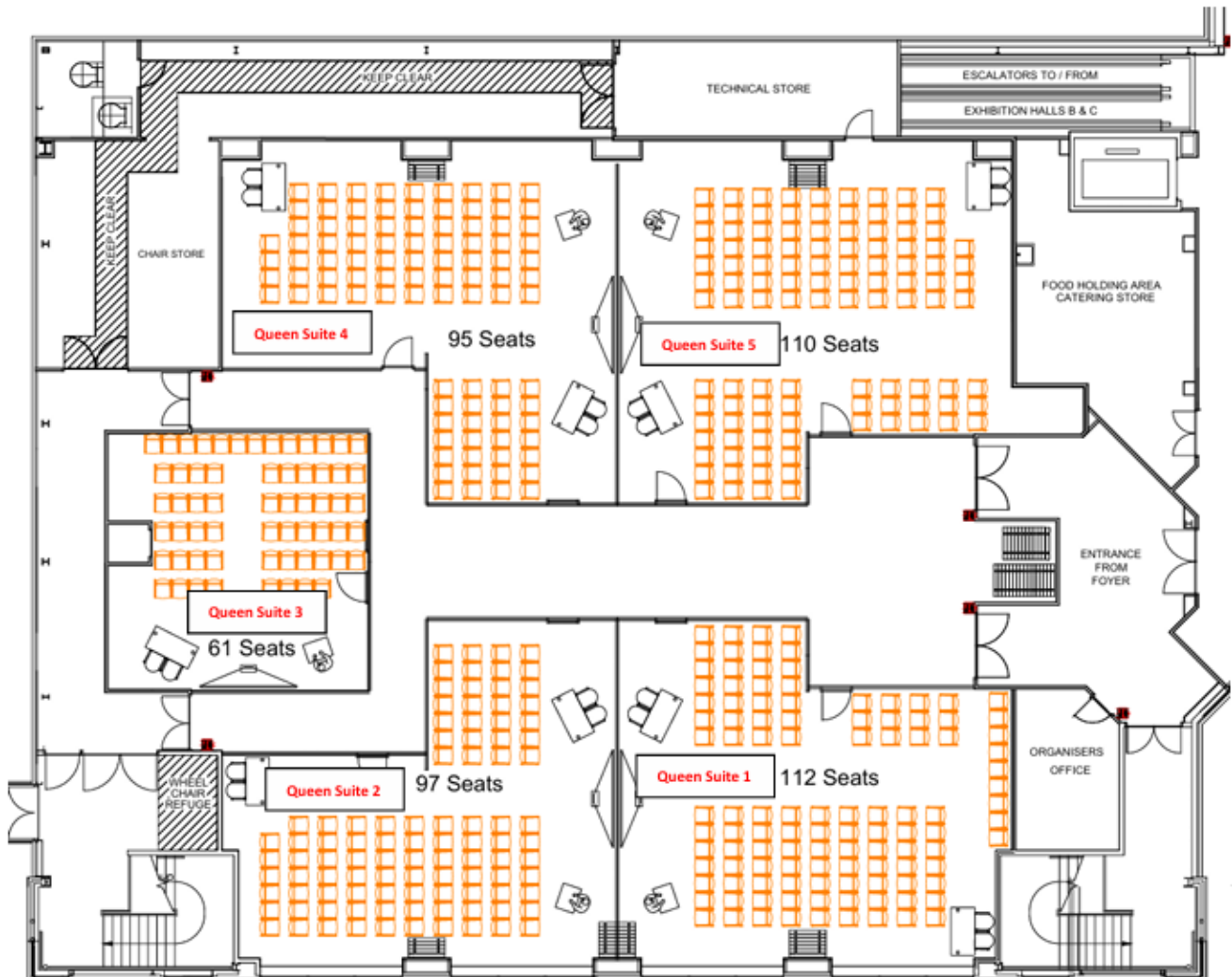

Travel & Accommodation

On the following pages you will find links and a useful guide that will help you organise your accommodation and travel. **UNFORTUNATELY TRAVEL AND ACCOMMODATION CANNOT BE SUPPORTED; YOU WILL NEED TO ARRANGE AND PAY FOR THIS YOURSELF.**

PARTICIPATION F2F AT THE UK ONCOLOGY FORUM, HARROGATE IS FULLY SUPPORTED WITH NO REGISTRATION FEE FOR UK HCPS ONLY AND INCLUDES: -

- participation in all scientific and educational live sessions with the possibility to interact with the expert panel
- onsite networking opportunity with Faculty and peers
- interaction with the industry partners in the exhibition hall
- participation in the industry satellite symposia
- at Harrogate Convention Centre only, allocated: -
 - coffee/tea breaks
 - Lunch
 - Conference

Accommodation

Please click on the link below which will direct you to accommodation in Harrogate

[Accommodation in Harrogate](#)

We're pleased to have secured a **20% discount** at the following hotel:

The Crown Hotel Harrogate

Crown Place, Harrogate
North Yorkshire
HG1 2RZ
United Kingdom

You can access the discounted rate via the link below — the 20% discount will be automatically applied to their best available rates:

 [Book Here](#)

Getting to Harrogate

Situated in the centre of the UK and equidistant from London and Edinburgh, the east coast and west coast, Harrogate Convention Centre is well connected by rail, road and air transport and easily accessible from all parts of the UK.



We have managed to secure a code for a discount on train travel for all UKOF attendees: - Harrogate is geographically right in the middle of the country and well served by all major transport links making it accessible from all corners of the UK and beyond. LNER Azuma services run 6 times a day direct between London Kings Cross and Harrogate Station (2 hours 46 minutes). [LNER](#) 25% discount is available online using **Promo Code: HCC2528**

Taxi services are available across the road opposite the main doors of the station. Convention Centre is just a seven-minute walk (or short taxi ride) from Harrogate train station

[25% off Harrogate International Centre | LNER](#)

Suitable trains from Glasgow to Harrogate

10.06.26	Glasgow Central	Harrogate	15:38hrs	20:41hrs	5hrs 3mins	(2 Changes)
12.06.26	Harrogate	Glasgow Central	15:52hrs	21:06hrs	5hrs 14mins	(2 Changes)

Suitable trains from Edinburgh to Harrogate

10.06.26	Edinburgh Waverly	Harrogate	14:52hrs	20:11hrs	5hrs 19mins	(2 Changes)
12.06.26	Harrogate	Edinburgh Waverly	14:50hrs	20:24hrs	5hrs 34mins	(2 Changes)

Suitable trains from Manchester to Harrogate

10.06.26	Manchester	Harrogate	15:30hrs	18:12hrs	2hrs 42mins	(2 Changes)
12.06.26	Harrogate	Manchester	15:52hrs	18:29hrs	2hrs 37mins	(2 Changes)

Taxis

Harrogate Convention Centre works with Harrogate's taxi drivers to keep them informed about upcoming events and to make sure they know when we are going to be busy. The nearest taxi rank is on Montpellier Road. Blue Line Taxis Tel: 01423 530 830 or Mainline Taxis Tel: 01423 555555 Taxis are readily available at Leeds / Bradford Airport and Harrogate train station.



Using Sat Nav

If you are using Sat Nav you can use the postcodes below or click on the name of each car park below for more information, including opening and closing times.

[Harrogate Convention Centre](#) – HG1 2HR.

[Jubilee Car Park](#) – HG1 1DJ

[Victoria Car Park](#) – HG1 5LQ

Please remember to check the closing times of your car park if you intend to stay late as vehicles locked in will be charged a release fee.

Google Maps

[Find us on Google Maps here](#)

From the South

21 minutes from the A1. Take the M1 and A1(M) before leaving at Junction 45 (Wetherby) then take the A661 to Harrogate. Alternatively continue on the A1(M) to Junction 47 (Knaresborough) then follow signs to Harrogate.

From the North

24 minutes from the A1. Take the A1(M) and exit at Junction 47 (Knaresborough) then follow signs to Harrogate.

Car parking

There is a 24-hour pay and display car park directly below the Harrogate Convention Centre and a further 1,200 parking spaces in the centre of Harrogate. There are also electric car charging points available just one minute from the venue. Whilst the Harrogate Convention Centre car park is available 24/7, please note that the entry and exit shutters are open from 06:00 to 23:59.

[Parking and EV Charging](#)



At 12 miles (20 minutes) the closest airport to Harrogate Convention Centre is [Leeds Bradford \(LBA\)](#). There are regular flights from locations across the UK and many connections worldwide, including Paris (1 hour 30 minutes), Amsterdam (1 hour 10 minutes), Dublin (1 hour)

To get from LBA to Harrogate, take the A2 bus which takes approximately 31 minutes, runs hourly and will drop you off at Harrogate's main bus station, from there it's a five-minute walk to the Convention Centre.

Alternatively, a taxi will take about 20 minutes and around £35.

If you are travelling from a destination without direct flights to LBA, consider a connection from Schiphol, Amsterdam.

[LNER | Azuma Harrogate Preview](#)

Suitable flights from Belfast City to Leeds Bradford

10.06.26	Air Lingus	Belfast City	Leeds Bradford	18:05hrs	19:15hrs	1hrs 10mins (Direct)
12.06.26	Air Lingus	Leeds Bradford	Belfast City	15:45hrs	16:55hrs	1hrs 10mins (Direct)
11.06.26	Air Lingus	Belfast City	Leeds Bradford	06:50hrs	08:hrs	1hrs 10mins (Direct)
12.06.26	Air Lingus	Leeds Bradford	Belfast City	15:45hrs	16:55hrs	1hrs 10mins (Direct)

Visit [Flights 10.06.26 - 12.06.26 from Belfast City Airport to Leeds Bradford](#).

Visit [Flights 11.06.26 - 12.06.26 from Belfast City Airport to Leeds Bradford](#).

[Getting here - Harrogate Convention Centre](#)

Banking

The venue has Cash Zone on the external walls of Hall M on King's Road, with numerous other cash points just a few minutes' walk away in the town centre. Some charges may apply to use these facilities.

Dates & Timings

Thursday 11th June 2026

Timings	Description
09:00hrs	Registration opens
09:00hrs to 10:30hrs	Further information to follow
10:00hrs to 11:45hrs	CCA-UK Meeting in partnership with BASL
10:00hrs to 11:45hrs	Cancer Alliances network meeting (Invitation Only)
10:30hrs to 11:30hrs	Sponsored Symposiums
11:45hrs to 12:45hrs	Diamond Sponsor Symposium
12:00hrs to 12:55hrs	Lunch & refreshments served in Studio One, Exhibition Hall
13:00hrs to 14:00hrs	Welcome by Professor Ruth Plummer (Chair) Opening Keynote Speaker (TBC)
14:00hrs to 14:25hrs	Refreshments served in Studio One, Exhibition Hall
14:30hrs to 17:25hrs	Clinical Sessions will run in parallel
17:30hrs to 17:45hrs	Diamond Sponsor Product Talk
17:30hrs to 18:45hrs	Hotspot Talks in Studio One, Exhibition Hall (further information to follow)
17:30hrs to 18:30hrs	Sponsored Symposiums
19:30hrs to 22:00hrs	Conference Dinner (limited spaces available)

Friday 12th June 2026

Timings	Description
07:30hrs	Registration Opens
08:00hrs to 08:45hrs	Sponsored Symposiums
09:00hrs to 11:45hrs	Clinical Sessions will run in parallel
11:15hrs to 11:45hrs	Hotspot Talks, refreshments served in Studio One, Exhibition Hall
12:00hrs to 12:55hrs	Closing Keynote Speaker (TBC)
13:00hrs to 14:00hrs	Hotspot Talks, lunch & refreshments served in Studio One, Exhibition Hall
13:15hrs to 14:00hrs	Sponsored Symposiums
13:45hrs to TBC	ACP Meeting Invitation ONLY
13:45hrs to TBC	ROUX Meeting Invitation ONLY
13:45hrs to TBC	DSU CRUK Meeting Open
13:45hrs to TBC	BCOG Invitation ONLY
13:45hrs to TBC	NOTCH AGM Open
14:00hrs	All depart

On arrival to the conference

Registration Desk

All relevant conference documentation should be collected from the UKOF26 Registration Desk. The desk will be situated at Entrance 1 (see map below)

Thursday 11th June 2026– 09:00hrs to 18:00hrs

Friday 12th June 2026– 07:30hrs to 14:00hrs

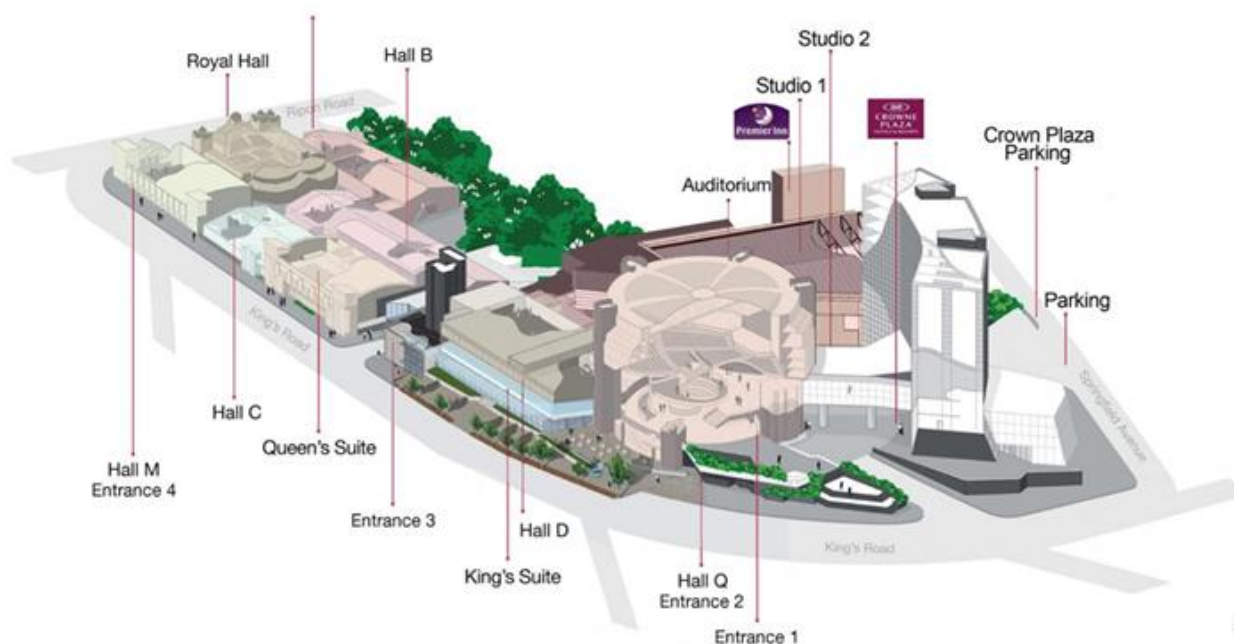

Delegate Badges & Programme

For security purposes, all delegates, accompanying persons and exhibitors must always wear the official UKOF26 delegate badges for entrance into the conference and conference dinner. Badges will be issued from the Registration Desk.

We will not have a printed programme for UKOF26. Delegates should instead use the UKOF26 App or save a copy of the Final Programme PDF to a tablet device

Sponsors have had NO input the educational programme or speaker choices. The programme has been wholly designed by the faculty and clinical session chairs. This meeting is open to UK cancer HCPs only. The industry symposia are NOT CME accredited. All registrants consent to names, institution and job titles being shared with all stakeholders. Contact Athena to withdraw consent.

Conference Catering

Delegate registrations will include complimentary lunch each day. A buffet lunch will be served on Thursday 11th & Friday 12th June in Studio One Exhibition Hall. A complimentary conference dinner will also take place on Thursday 11th June from 19:30hrs in the Hall D, at the Harrogate Convention Centre. Please confirm your attendance to this on registration. **Please note soft drinks will only be served. A bar is available for you to purchase beer, wine and spirits if required – credit card only.**

UKOF26 APP

You will receive an email notification of the **UKOF26 App** two days prior to the conference. Please download this prior to attending. This will provide you with detailed information about the conference, the exhibitors, speakers, programme etc.

Social media – LinkedIn / X / Instagram

UKOF26 is on X, LinkedIn and Instagram @OncologyForum (and the hashtags #UKOF26). Please keep up to date with all UK Oncology Forum on X also. Please also join the LinkedIn UK Oncology Forum group.



WIFI

A Wi-Fi service is available in all areas of the venue. This is a complimentary service.

Programme

Please visit [UK Oncology Forum Programme](#) and click on Programme link.

Confirmed Industry Symposia

Please check the Industry Symposia section on the website regularly. Industry Symposia agendas will be added when finalised and approved - [CLICK HERE - Industry Symposia Page](#).

Certificate of Attendance

The meeting will be CME accredited by the RCP. To receive your certificate of attendance, you will be required to complete the UKOF26 delegate survey.

Certificates will be emailed after the meeting, usually in September, to all delegates who have completed the survey.

The link to the UKOF26 delegate survey will be available on the UKOF26 App.

Dress Code

Business casual for the whole meeting.

ABPI Code of Conduct

The programme has been designed and developed solely by the UK Oncology Forum Faculty. No sponsors have any input or influence over the programme. This meeting is for UK Oncology Healthcare Professionals only. The meeting will run strictly in accordance with the ABPI Code of Practice. The varying sponsorships packages are primarily for the purchase of promotional exhibition stand space. Commercial personnel from industry, please be aware that in the tumour specific clinical streams, there could be discussion of “off license” products from ASCO updates.

Children

For Health and Safety reasons no children allowed to attend the conference.

Damage & Loss

Neither Athena Meetings & Events, nor the Harrogate Convention Centre and Crowne Plaza, accept any responsibility for damage or loss of any properties.

Evacuation Procedures

In the event of an emergency evacuation please follow the instructions of Harrogate Convention Centre and Fire Marshals (identified by high visibility jackets).

Lost Property

Lost property should be handed in to the Registration desk at Entrance 1.

Smoking/E Cigs

If you wish to smoke, you may do so outside of the venue in the designated smoking areas. Using e-cigs or vaping is not permitted inside the venue.

Contact Information

LISA YOUNG

Project Director

Athena Meetings & Events

Email: lisa@athenameetings.com

Direct Line: +44 (0)1625 619450

Mobile +44 (0)7798 888 627

DEAN BARLOW

Exhibitor Director

Athena Meetings & Events

Email: dean@athenameetings.com

Mobile +44 (0)7796 264246

SHARON POOLE

Congress Director

Athena Meetings & Events

Email: sharon@athenameetings.com

Mobile +44 (0)780 107 5806